

Soils Map

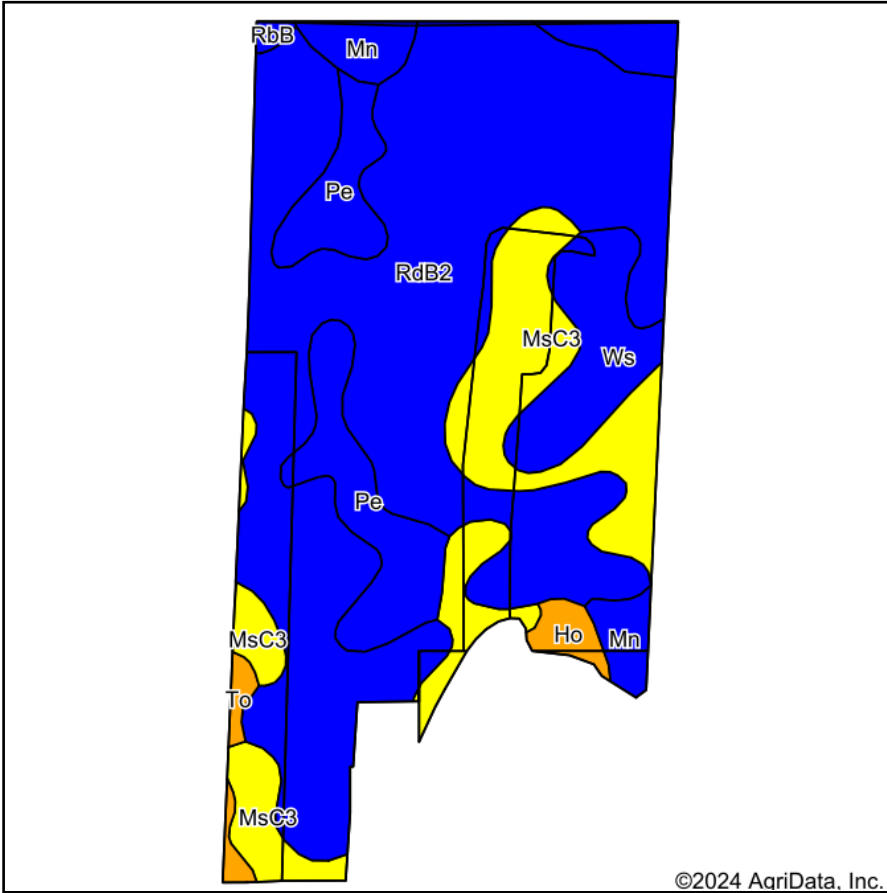

Soils data provided by USDA and NRCS.

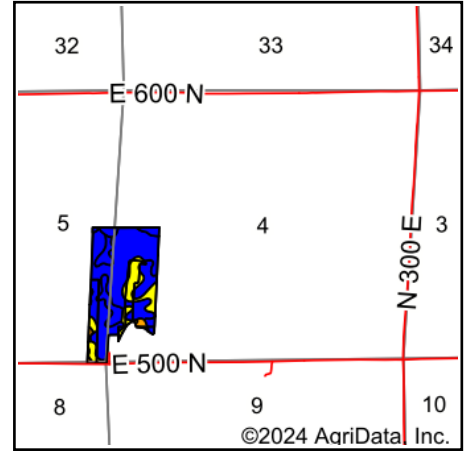

State: **Indiana**
 County: **Noble**
 Location: **4-34N-10E**
 Township: **Jefferson**
 Acres: **55.39**
 Date: **10/17/2024**



Area Symbol: IN113, Soil Area Version: 29

Code	Soil Description	Acres	Percent of field	Non-Irr Class Legend	Non-Irr Class	Corn Bu	Corn silage Tons	Grass legume hay Tons	Grass legume pasture AUM	Pasture AUM	Soybeans Bu	Winter wheat Bu
RdB2	Rawson, Morley, and Miami loams, 2 to 6 percent slopes, eroded	32.87	59.3%	Blue	Ile	124	17	4		8	44	56
MsC3	Morley silty clay loam, 6 to 12 percent slopes, severely eroded	9.27	16.7%	Yellow	IVe	105	15	4	7		37	47
Pe	Pewamo silty clay loam, 0 to 1 percent slopes	5.57	10.1%	Blue	IIw	157		5	11		47	64
Ws	Washtenaw silt loam	3.56	6.4%	Blue	IIw	170	22	6		11	51	68
Mn	Milford silty clay loam, 0 to 2 percent slopes	2.75	5.0%	Blue	IIw	154		5		11	43	62
Ho	Houghton muck, drained	0.67	1.2%	Orange	IIIw	159		5		11	42	64
To	Toledo silty clay loam	0.53	1.0%	Orange	IIIw	155	21	5		10	44	62
RdB	Rawson loam, 2 to 6 percent slopes	0.17	0.3%	Blue	Ile	143	20	5		10	50	65
Weighted Average					2.36	129.4	14.3	4.3	2.3	6.3	43.5	56.5

Soils data provided by USDA and NRCS.