

REAL ESTATE

Listing

PROPERTY FOR SALE

CLINTON COUNTY, IN • 2.97± ACRES
COMMERCIAL LOT • WARREN TOWNSHIP

On the SW corner of State Road 26 and State Road 29 in northern Clinton County. West of Russiaville & East of Rossville



PROPERTY DETAILS:



TOTAL ACRES:
2.97± ACRES



PRICE (REDUCED):
\$40,000

Listing Type: Clinton County Indiana Commercial

Lot SR26 & SR29

Total Acres: 2.97

Roads/Water: 0.06

Section: 27

Township: Warren

County: Clinton

State: Indiana

Price (Reduced): \$50,000

Owner: Derhammer

Location: West of Russiaville and East of Rossville at the intersection of State Road 26 and State Road 29 in NE Clinton County.

Easements: Billboard Easement

Taxes: \$586.74 Annually

Possession: At Closing

Zoning: Commercial Vacant Land #400

Directions: On the SW corner of State Road 26 and State Road 29 in northern Clinton County.

Electric Source: Duke Energy

The information on this sheet is subject to verification and no liability for errors or omissions is assumed by the Schrad Auction Agency.

Derhammer • TF35C



800.451.2709
schradauction.com/listings

Listing Agents: TODD FREEMAN
765-414-1863
todd@schradauction.com

REAL ESTATE

Listing

PROPERTY FOR SALE

CLINTON COUNTY, IN • 2.97± ACRES
COMMERCIAL LOT • WARREN TOWNSHIP

On the SW corner of State Road 26 and State Road 29 in northern Clinton County.
West of Russiaville & East of Rossville

AERIAL MAP



SOIL MAP



LOCATION MAP

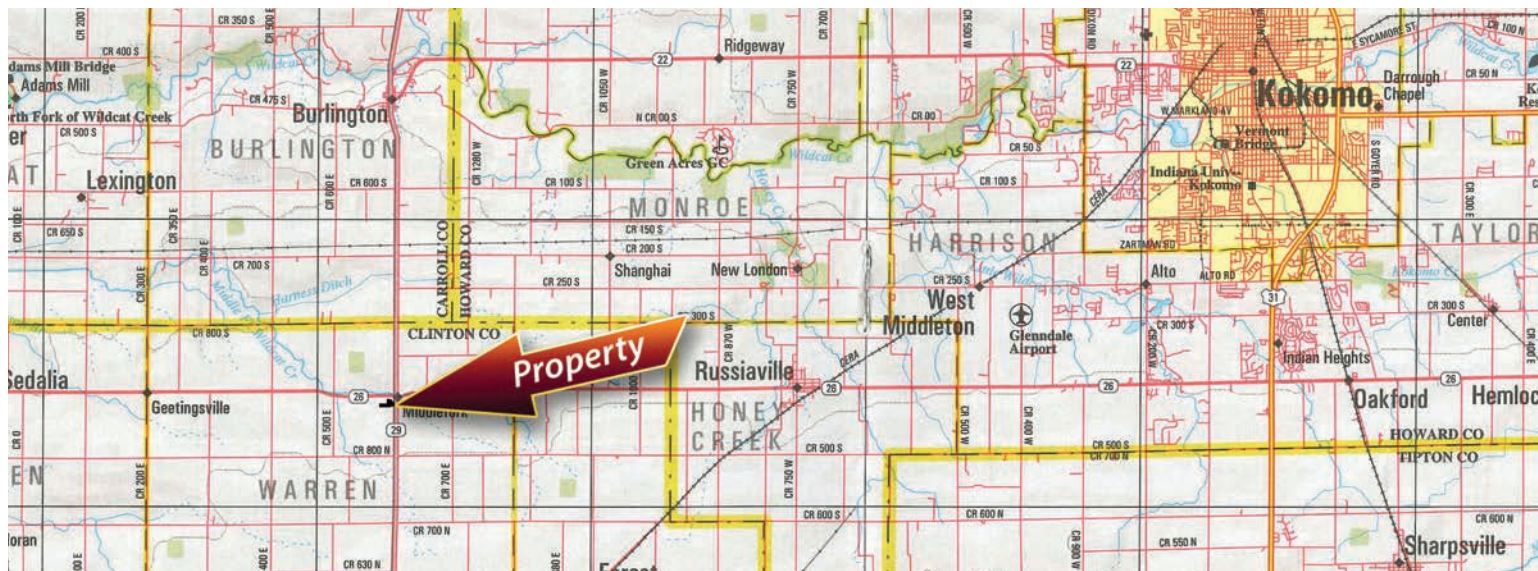

The information on this sheet is subject to verification and no liability for errors or omissions is assumed by the Schrader Agency.

Derhammer • TF35C



800.451.2709
schradauction.com/listings

Listing Agents: TODD FREEMAN
765-414-1863
todd@schradauction.com